

NOTES TO USERS

This map is for use in administering the National Flood Insurance Program. It does not necessarily identify all areas subject to flooding, particularly from local drainage sources of small size. The community map repository should be consulted for possible updated or additional flood hazard information.

To obtain more detailed information in areas where **Base Flood Elevations (BFEs)** and/or **floodways** have been determined, users are encouraged to consult the Flood Profiles and Floodway Data and/or Summary of Stillwater Elevations tables contained within the Flood Insurance Study (FIS) report that accompanies this FIRM. Users should be aware that BFEs shown on the FIRM represent rounded whole-foot elevations. These BFEs are intended for flood insurance rating purposes only and should not be used as the sole source of flood elevation information. Accordingly, flood elevation data presented in the FIS report should be utilized in conjunction with the FIRM for purposes of construction and/or floodplain management.

Boundaries of the **floodways** were computed at cross sections and interpolated between cross sections. The floodways were based on hydraulic considerations with regard to requirements of the National Flood Insurance Program. Floodway widths and other pertinent floodway data are provided in the Flood Insurance Study report for this jurisdiction.

The **projection** used in the preparation of this map was Texas State Plane South Central Zone (FIPS zone 4204). The **horizontal datum** was NAD 83, GRS 80 spheroid. Differences in datum, spheroid, projection or State Plane zones used in the production of FIRMs for adjacent jurisdictions may result in slight positional differences in map features across jurisdiction boundaries. These differences do not affect the accuracy of this FIRM.

Flood elevations on this map are referenced to the North American Vertical Datum of 1988. These flood elevations must be compared to structure and ground elevations referenced to the same **vertical datum**. For information regarding conversion between the National Geodetic Vertical Datum of 1929 and the North American Vertical Datum of 1988, visit the National Geodetic Survey website at <http://www.ngs.noaa.gov> or contact the National Geodetic Survey at the following address:

NGS Information Services
NOAA, NGS12
National Geodetic Survey
SSMC-3, #9202
Silver Spring, Maryland 20910-3282
(301) 713-3242

To obtain current elevation, description, and/or location information about the **bench marks** shown on this map, please contact the Information Services Branch of the National Geodetic Survey at (301) 713-3242, or visit their website at <http://www.ngs.noaa.gov/>.

Base map information shown on this FIRM was provided for Bexar County by Petroleum Place Energy Solutions, L.P. The vector data was derived from Aerial Photography, dated 2006 and captured at a resolution of 1:800.

This map reflects more detailed up-to-date **stream channel configurations** than those shown on the previous FIRM for this jurisdiction. The floodplains and floodways that were transferred from the previous FIRM may have been adjusted to conform to these new stream channel configurations. As a result, the Flood Profiles and Floodway Data tables in the Flood Insurance Study report (which contains authoritative hydraulic data) may reflect stream channel distances that differ from what is shown on this map.

Corporate limits shown on this map are based on the best data available at the time of publication. Because changes due to annexations or de-annexations may have occurred after this map was published, map users should contact appropriate community officials to verify current corporate limit locations.

Please refer to the separately printed **Map Index** for an overview map of the county showing the layout of map panels; community map repository addresses; and a Listing of Communities table containing National Flood Insurance Program dates for each community as well as a listing of the panels on which each community is located.

Contact the **FEMA Map Service Center** at 1-800-358-9616 for information on available products associated with this FIRM. Available products may include previously issued Letters of Map Change, a Flood Insurance Study report, and/or digital versions of this map. The FEMA Map Service Center may also be reached by Fax at 1-800-358-9620 and their website at <http://msc.fema.gov>.

If you have **questions about this map** or questions concerning the National Flood Insurance Program in general, please call 1-877-FEMA-MAP (1-877-336-2627) or visit the FEMA website at <http://www.fema.gov/business/info>.

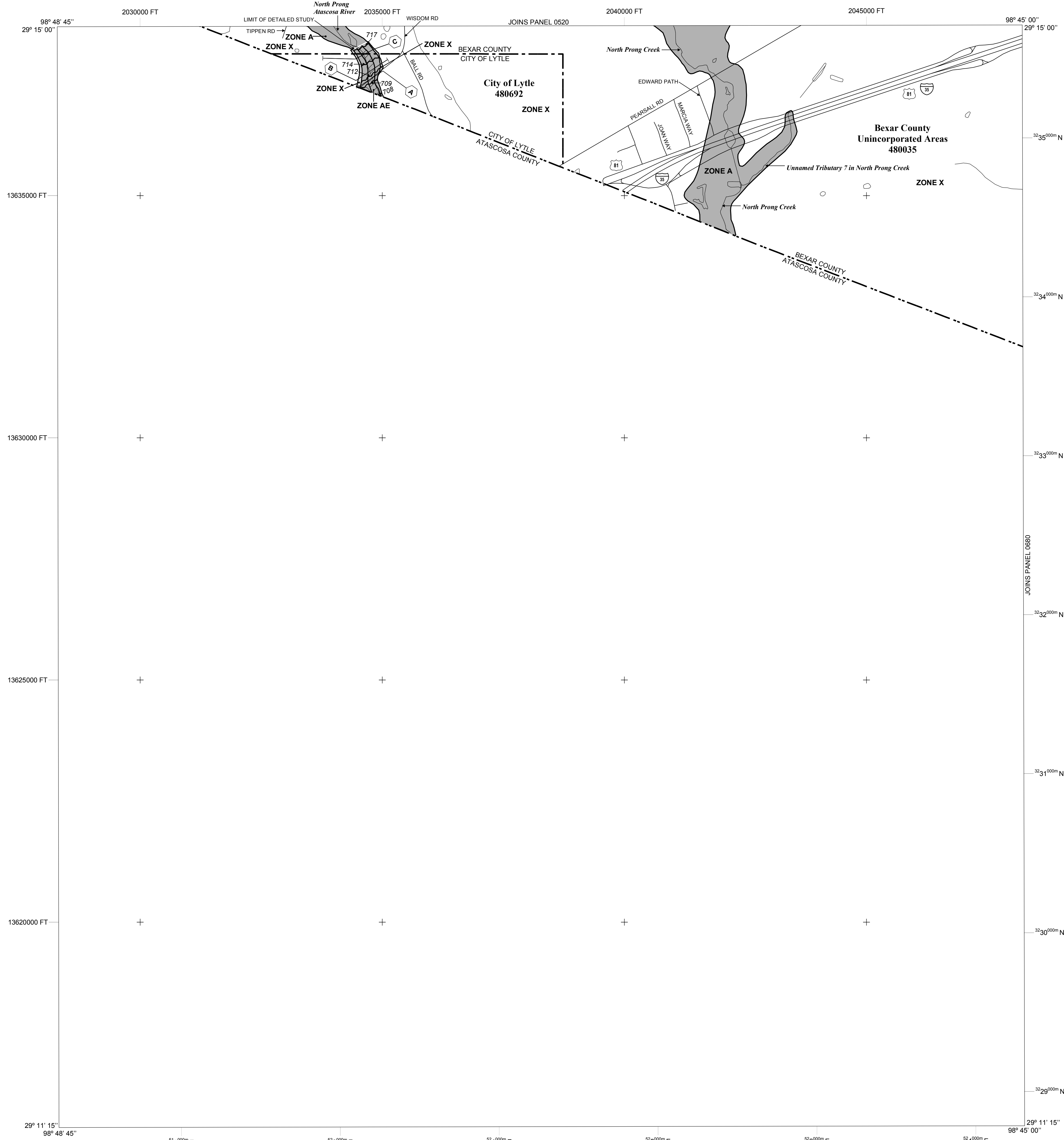

LEGEND

- SPECIAL FLOOD HAZARD AREAS (SFHAs) SUBJECT TO INUNDATION BY THE 1% ANNUAL CHANCE FLOOD
- ZONE A**
No Base Flood Elevations determined.
- ZONE AE**
Base Flood Elevations determined.
- ZONE AH**
Flood depths of 1 to 3 feet (usually areas of ponding); Base Flood Elevations determined.
- ZONE AR**
Flood depths of 1 to 3 feet (usually sheet flow on sloping terrain); average depths determined. For areas of alluvial fan flooding, velocities also determined. Special Flood Hazard Areas formerly protected from the 1% annual chance flood by a flood control system that was subsequently derelict. Zone AR indicates that the former flood control system is being restored to provide protection from the 1% annual chance or greater flood.
- ZONE A99**
Area to be protected from 1% annual chance flood by a Federal flood protection system under construction; no Base Flood Elevations determined.
- ZONE V**
Coastal flood zone with velocity hazard (wave action); no Base Flood Elevations determined.
- ZONE VE**
Coastal flood zone with velocity hazard (wave action); Base Flood Elevations determined.
- FLOODWAY AREAS IN ZONE AE
- OTHER FLOOD AREAS**
- ZONE X**
Areas of 0.2% annual chance flood; areas of 1% annual chance flood with average depths of less than 1 foot or with drainage areas less than 1 square mile; and areas protected by levees from 1% annual chance flood.
- ZONE X (Future Base Flood)**
Areas of 1% annual chance flood based on future conditions hydrology. No Base Flood Elevations determined.
- OTHER AREAS**
- ZONE X**
Areas determined to be outside the 0.2% annual chance floodplain.
- ZONE D**
Areas in which flood hazards are undetermined, but possible.
- COASTAL BARRIER RESOURCES SYSTEM (CBRS) AREAS
- OTHERWISE PROTECTED AREAS (OPAs)
- CBRS areas and OPAs are normally located within or adjacent to Special Flood Hazard Areas.
- Floodplain Boundary
- Floodway boundary
- Zone D boundary
- CBRS and OPA boundary
- Boundary dividing Special Flood Hazard Areas of different Base Flood Elevations, flood depths or flood velocities.
- Base Flood Elevation line and value; elevation in feet*
- Base Flood Elevation value where uniform within zone; elevation in feet* (EL. 987)

*Referenced to the North American Vertical Datum of 1988

- Cross section line
- Transect line
- 45° 02' 08", 93° 02' 12" Geographic coordinates referenced to the North American Datum of 1983 (NAD 83) Western Hemisphere
- 4989000FT 5000-foot grid ticks: Texas State Plane coordinate system, south central zone (FIPS Zone 4204), Transverse Mercator
- 4989000m 1000-meter Universal Transverse Mercator grid values, Zone 14
- DX5510 x Bench mark (see explanation in Notes to Users section of this FIRM panel)
- * M1.5 River Mile

MAP REPOSITORIES
REFER TO LISTING OF MAP REPOSITORIES ON MAP INDEX

EFFECTIVE DATE OF COUNTYWIDE FLOOD INSURANCE RATE MAP
FEBRUARY 16, 1996

EFFECTIVE DATE(S) OF REVISION(S) TO THIS PANEL

(Date of Revision) - to change the Base Flood Elevations, Special Flood Hazard Areas, floodway and zone designations, to add Base Flood Elevations, Special Flood Hazard Areas, roads and road names; to reflect updated topographic information; to incorporate previously issued Letters of Map Revision and to update corporate limits.

For community map revision history prior to countywide mapping, refer to the Community Map History table located in the Flood Insurance Study report for this jurisdiction.

To determine if flood insurance is available in this community contact your insurance agent or call the National Flood Insurance Program at 1-800-638-6620.

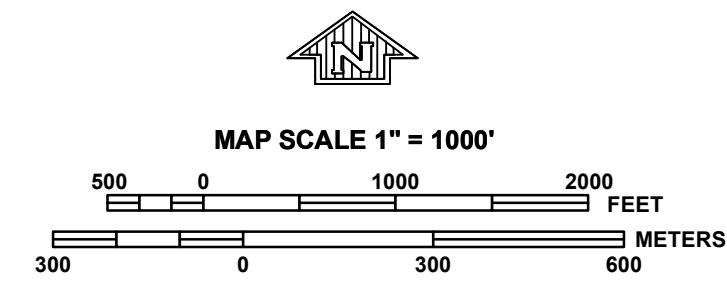

PANEL 0660F

FIRM
FLOOD INSURANCE RATE MAP

BEXAR COUNTY, TEXAS
AND INCORPORATED AREAS

PANEL 660 OF 785

(SEE MAP INDEX FOR FIRM PANEL LAYOUT)

CONTAINS:

COMMUNITY	NUMBER	PANEL	SUFFIX
BEXAR COUNTY	480035	0660	F
LYTLE, CITY OF	480692	0660	F

PRELIMINARY

Sep 28 2007

Notice to User: The **Map Number** shown below should be used when placing map orders; the **Community Number** shown above should be used on insurance applications for the subject community.

MAP NUMBER
48029C0660F

MAP REVISED

Federal Emergency Management Agency